

# **BOSE**<sup>®</sup>

## mobile on-ear headset

Owner's Guide  
Brugervejledning  
Bedienungsanleitung  
Guía de usuario  
Omistajan opas  
Notice d'utilisation  
Felhasználói útmutató  
Manuale di istruzioni  
Gebruiksaanwijzing  
Podręcznik użytkownika  
Bruksanvisningen  
දුරකථන  
사용자 안내서  
用户指南  
دليل المالك



## SAFETY INFORMATION

---

### Please read this owner's guide

Please take the time to follow the instructions in this owner's guide carefully. It will help you set up and properly use your new headset. Please save this owner's guide for future reference.

### CAUTIONS

- *Long-term exposure to loud music may cause hearing damage. Please avoid extreme volume when using headsets, especially for extended periods.*
- *Do not use headsets when operating a motor vehicle or anywhere the inability to hear outside sounds may present a danger to you or others.*
- *Sounds that you rely on as reminders or warnings may have an unfamiliar character when using headsets. Be aware of how these sounds may vary in character so you can recognize them as needed.*
- *Do not drop, sit on, or allow the headsets to be immersed in water.*



This product conforms to the EMC Directive 89/336/EEC. The complete Declaration of Conformity can be found at [www.Bose.com/compliance](http://www.Bose.com/compliance).

**WARNING:** *DO NOT use mobile phone adapters to connect headset to airplane seat jacks as this could result in personal injury such as burns or property damage due to overheating. Remove and disconnect immediately if you experience warming sensation or loss of audio.*

©2009 Bose Corporation. No part of this work may be reproduced, modified, distributed, or otherwise used without prior written permission. All trademarks referenced herein are property of Bose Corporation.

## USING YOUR HEADSET

### Introduction

Thank you for purchasing the Bose® mobile on-ear headset. The Bose® mobile on-ear headset delivers quality audio in a comfortable, lightweight and compact design. The headset cord with inline microphone lets you fully enjoy music on your phone by providing Bose quality sound and a comfortable fit while allowing you to take calls with ease. Enjoy music where noise can be a distraction—and never miss a call. Enjoy sound performance with lifelike quality and range. Fold-flat earcups and a collapsible headband offer increased portability and easy storage in the included carrying case. Bose sound for on-the-go enjoyment.

Your Bose® mobile on-ear headset includes:

- On-ear headset
- Headset cord with inline microphone
- Three 3.5mm to 2.5mm mobile phone adapters
- Carrying case

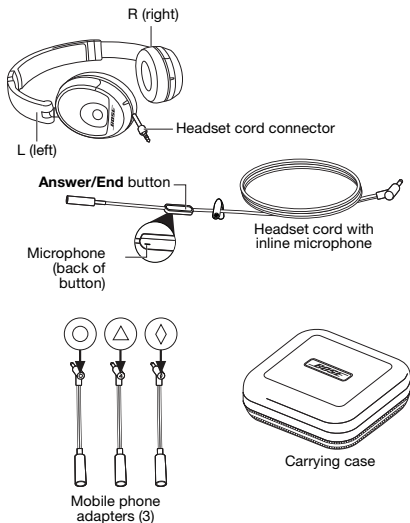

## USING YOUR HEADSET

### Putting the headset in the case

1. Rotate the earcups until the cushions face you.
2. Pivot the earcups into the headband and place the headset in the case.

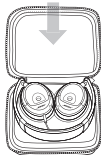

### Taking the headset out of the case

1. Lift the headset out of the case and pivot the earcups out of the headband.
2. Rotate the earcups until the cushions face each other.



**Note:** Do not try to exceed the limits of the pivots or over-rotate the earcups.

## USING YOUR HEADSET

### Connecting to a mobile phone or audio device

You can connect the headset to your mobile phone with either the 3.5 mm stereo plug (compatible with standard headphone jacks) or by using one of the three included 2.5mm adapter cables if needed.

The correct connection should allow:

- Stereo sound to be heard during music playback and communications
- Your voice to be heard by the person on the other end of a phone call
- The Answer/End button to operate as expected

Compatible with many music-enabled mobile phones. Refer to the enclosed compatibility list or visit [www.Bose.com/phones](http://www.Bose.com/phones) for the latest list of compatible phones.

First, attach the headset cord to the headset cord connector.

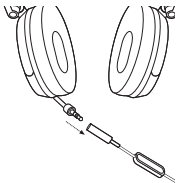

#### Without adapter

If your phone has a 3.5mm headphone/headset jack, you do not need to use the included adapters.



1. Plug the headset into the headphone/headset jack on the phone.
2. Put on the headset.



## USING YOUR HEADSET

### With adapter

The Bose® mobile on-ear headset includes three unique phone adapters. Each one is identified by a small symbol (circle, diamond, triangle) on the top of the plug.

If your phone has a 2.5mm headphone/headset jack, you will need to use one of these adapters.

Refer to [www.Bose.com/phones](http://www.Bose.com/phones) to determine which adapter is compatible with your phone.

1. Select the appropriate adapter.
2. Attach the adapter to the headset cable.
3. Plug the headset with the adapter into the headphone/headset jack on the phone.
4. Put on the headset.

**Note:** If your phone does not respond when you press the Answer/End button, you are getting partial or no sound, or the microphone is not picking-up sound, you may be using the wrong adapter. Refer to [www.Bose.com/phones](http://www.Bose.com/phones) to determine which adapter is compatible with your phone.

● Device with 2.5mm headphone/headset jack

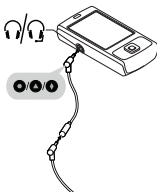

### Answering and ending calls

The Bose® mobile on-ear headset includes an easy to access Answer/End button with integrated microphone. Simply press the Answer/End button to perform an action.

**Note:** Some phones may require you to press and hold the Answer/End button for a few seconds to perform functions.

#### Answering calls

When you receive an incoming call, press and release the Answer/End button to answer.

#### Ending calls

When you are ready to end your call, press and release the Answer/End button.



**Note:** Some unique phone and music playback functions, like last number redial, voice commands, and track navigation are device-dependant, and may be accessible using the Answer/End button. Refer to your mobile phone user's manual to find out what features are available.

## Wearing the headset

After removing the headset from the case and unfolding the earcups (see page 4), put on the headset using the markings on the headband that identify the left (L) and right (R) earcups.

## Using the “enhancement” features of audio devices

Many portable audio devices include features or settings which electronically alter the audio signal sent to the headset. These may include “bass boost” or other EQ settings. Other features may serve to limit volume out such as “sound check” or “volume limit.” Finally, other features add spatialization effects such as “Surround”, “SMS”, “WOW”, or “3D.”

The Bose® mobile on-ear headset was designed to deliver high quality, balanced sound and deep, low notes without the need for any artificial enhancement. Therefore, when using the headset we recommend that you first **turn off** all the enhancement features before making any personal adjustments to the audio settings.

## Cleaning the headset

Should cleaning be necessary, simply wipe the outside surfaces with a damp cloth. Be sure the earcup ports are kept clear and that no moisture is allowed to get inside the earcup or microphone opening.



## Reattaching earcup cushions

If an earcup cushion becomes detached from the earcup:

1. Align the two holes on the back of the cushion with the two posts on the earcup.
2. Push the cushion onto the earcup.
3. Press in around the outside edge of the cushion to snap it in place.

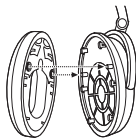

Make sure the cushion is flush all the way around and that there are no gaps between the cushion and the earcup.

## REFERENCE

### Replacement parts and accessories

Accessories or replacement parts can be ordered through Bose Customer Service.

See the contact information for your area included in this guide.

- Carrying case
- Headset cord with inline microphone
- Mobile phone adapters
- Replacement Ear Cushion Kit

### Troubleshooting

If you experience any trouble using your headset, try the following troubleshooting instructions. If you still need help, call for assistance. See the contact information on the inside back cover.

Problem	What to do
No audio	<p><i>FROM MOBILE PHONE</i></p> <p>Make sure you are using the correct mobile phone adapter, if required. See included compatibility chart.</p> <p>Make sure that the headset plug is securely connected to the headphone/headset jack (not the line out jack).</p> <p><i>FROM AUDIO DEVICE</i></p> <p>Make sure that the headset cord is securely connected to the headset and to the headset jack (not the line out jack) of the audio device.</p>
Intermittent audio	<p>Make sure that the headset plug is securely connected to the headphone/headset jack (not the line out jack).</p>
Excessive bass	<p>Turn off any audio enhancement features on the audio source.</p>
Low volume/poor audio	<p>Turn off any "sound checker" or other audio signal altering features on the audio source.</p>



<b>Problem</b>	<b>What to do</b>
Sound is coming from only one earpiece	Make sure you are using the correct mobile phone adapter and that it is securely connected.
Incoming call ring tone not heard through headset	Make sure your phone is set to pass the ring tone through to the headset. Check your phone settings and make adjustments as needed. <b>Note:</b> <i>This feature may not be available on all phones.</i>
Distorted bass	Make sure that the earcup ports are not blocked in any way. If they are dirty, gently wipe away any debris. Also check to see that the cushions are completely snapped onto the earcups.
Microphone is not picking-up sound	Make sure you are using the correct mobile phone adapter and that it is securely connected. Make sure the microphone is not being blocked or covered. <b>Note:</b> <i>The microphone is located on the back of the Answer/End button (you may notice the small opening for the microphone).</i>
Phone not responding when Answer/End button is pressed	Make sure you are using the correct mobile phone adapter and that it is securely connected. <b>Note:</b> <i>Some phones may require you to press and hold the Answer/End button for a few seconds to perform functions.</i>
Phone unexpectedly ends call	Some phones will end a call if the headset is unplugged during a call. Make sure that the headset plug is securely connected to the headphone/headset jack.
Misshaped cushions	The cushions may appear deformed when removed from the case or the packaging. However, after a few minutes the cushions should regain their natural shape.

# BOSE CORPORATION

---

## **Australia**

Unit 3/2 Holker St. Newington NSW,  
2127  
1800 023 367  
www.Bose.com.au

## **Belgique/Belgie**

B-3700 Tongeren  
012-390800

## **China**

2203-2305 22F, West Gate Tower/1038  
West Nanjing Road-MeiLongzhen  
Plaza, Shanghai, 200041  
86-22-62713000 ext. 162  
www.Bose.cn

## **Denmark**

2605 Brøndby  
04343-7777  
www.Bose.dk

## **Deutschland**

D-61381 Friedrichsdorf  
06172-71040  
www.Bose.de

## **France**

78100 Saint Germain en Laye  
01-30616363  
www.Bosefrance.fr

## **India**

Shriram Bhartiya Kala Kendra, 1  
Copernicus Marg, New Delhi, 100-001  
91-11-2307-3825-3826-3827  
www.Boseindia.com

## **Ireland**

Castlebury Road, Carrickmacross,  
Co Monaghan  
042-9671500  
www.Bose.ie

## **Italia**

Via della Magliana 876 Roma, 00148  
06.60.292.555  
www.Bose.it

## **Japan**

Karakida Center bldg., 1-53-9  
Karakida, Tama-shi, Tokyo, 2060035  
81-423-575250  
www.Bose.co.jp

## **Mexico**

Paseo de las Palmas # 405, 11000  
52-55-52-02-35-45  
FAX: 52-55-52-02-41-95

## **Nederland**

1135 GE Edam  
0299-390111  
www.Bose.nl

## **New Zealand**

0800 501 511  
[www.Bose.co.nz](http://www.Bose.co.nz)

## **Norge**

N-2213 Kongsvinger  
62-82-15-60  
[www.Bose.no](http://www.Bose.no)

## **Österreich**

Wienerbergstrasse 7 (10.OG)  
01-60404340  
[www.Bose.at](http://www.Bose.at)

## **Schweiz**

Hauptstrasse 134  
061-9757733  
[www.Bose.ch](http://www.Bose.ch)

## **Sverige**

S-43153 Mölndal  
031-878850  
[www.Bose.se](http://www.Bose.se)

## **United Kingdom**

1 Ambley Green,  
Gillingham Business Park,  
Gillingham, Kent, ME8 ONJ  
0780-741-4500  
[Info\\_uk@Bose.com](mailto:Info_uk@Bose.com)

## **Hong Kong**

Suite 1203, Midas Plaza,  
1 Tai Yau Street, San Po Kong,  
Kowloon, Hong Kong  
(852) 21239000  
[support\\_hk@Bose.com](mailto:support_hk@Bose.com)

## **Finland**

Kornetintie 6b Helsinki, 380  
+358 10 778 6900  
[www.Bose.fi](http://www.Bose.fi)

## **Poland**

ul. Woloska 12 Warszawa, 02-675  
+48 (0)22-8522928  
[www.Bose.pl](http://www.Bose.pl)

## **Canada**

9133 Leslie Street,  
Suite 120, L4B 4N1  
800-465-2673  
[www.Bose.ca](http://www.Bose.ca)

## **USA**

The Mountain,  
Framingham, MA, 01701  
800-367-4008  
508-766-1900  
[www.Bose.com](http://www.Bose.com)

## **World Wide Web**

[www.Bose.com](http://www.Bose.com)  
[www.Boseeurope.com](http://www.Boseeurope.com)



319137-0010

***BOSE***<sup>®</sup>  
*Better sound through research*<sup>®</sup>

©2009 Bose Corporation, The Mountain,  
Framingham, MA 01701-9168 USA  
AM319137 Rev.01